

EVAPCO, INC.



UNIT	EVAPORATIVE CONDENSER	MODEL #	LRC-131	SCALE	NTS	DWG. #	CP122410-ERE-RS	REV.		DATE	5/19/2024	SERIAL #	
------	-----------------------	---------	---------	-------	-----	--------	-----------------	------	--	------	-----------	----------	--

NOTES:

1. (M) - FAN MOTOR LOCATION
2. HEAVIEST SECTION IS UPPER SECTION
3. MPT DENOTES MALE PIPE THREAD
FPT DENOTES FEMALE PIPE THREAD
BFW DENOTES BEVELED FOR WELDING
4. † UNIT WEIGHT DOES NOT INCLUDE ACCESSORIES (SEE SEPARATE DRAWINGS FOR ACCESSORIES)
5. 3/4" DIA. MOUNTING HOLES. REFER TO RECOMMENDED STEEL SUPPORT DRAWING
6. * - APPROXIMATE DIMENSIONS DO NOT USE FOR PRE-FABRICATION OF CONNECTING PIPING.

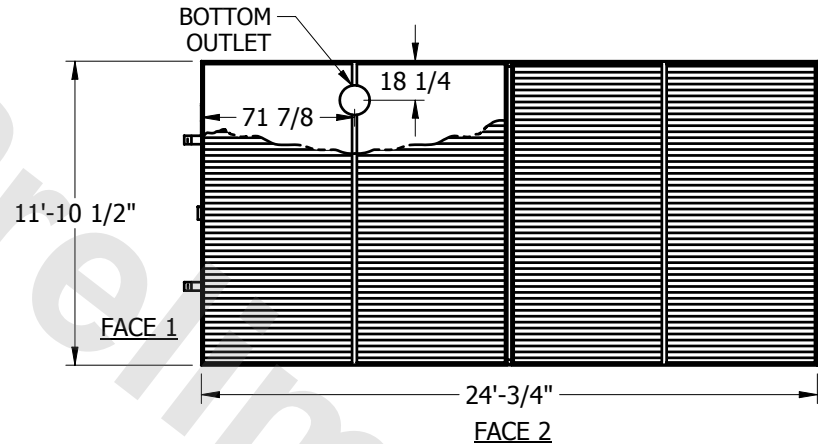

PLAN VIEW

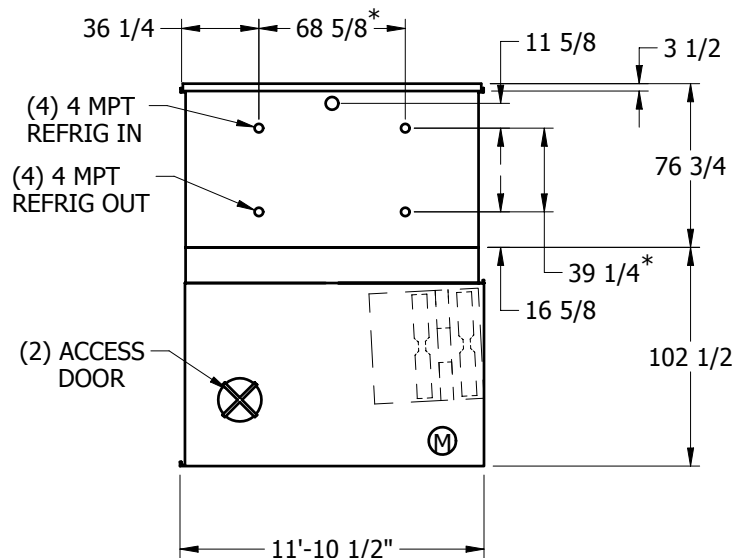

FACE 1

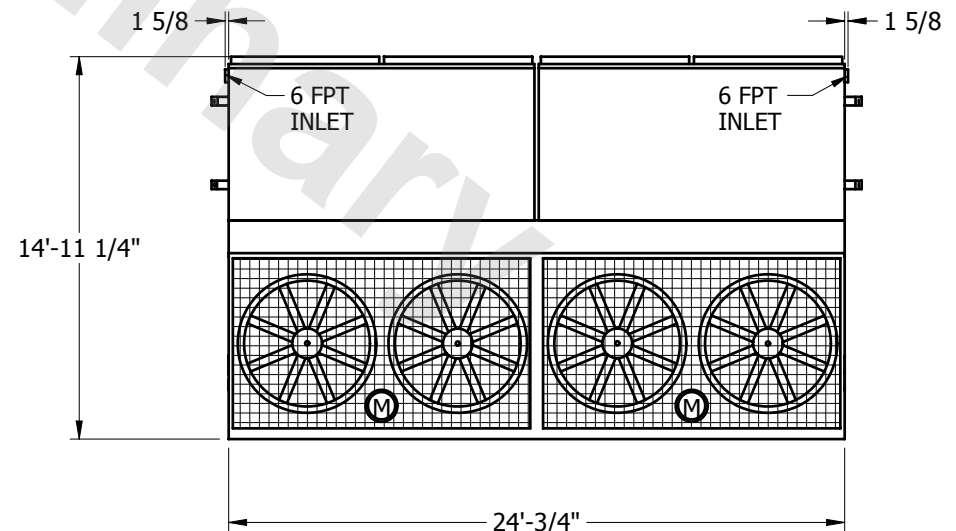

FACE 2

SHIPPING WEIGHT	40990	lbs.†	OPERATING WEIGHT	48600	lbs.	HEAVIEST SECTION WEIGHT	15790	lbs.	NO. OF SHIPPING SECTIONS	3
-----------------	-------	-------	------------------	-------	------	-------------------------	-------	------	--------------------------	---